

LPGS Series-Gel Battery RMTS2-1000(2V1000Ah)



SPECIFICATIONS

| | | |
|-------------------------------|---|----------------------------|
| Rated Voltage | 2V | |
| Nominal Capacity | 1000.0Ah (C ₁₀ , 1.80V/cell) | |
| Dimension | Length | 475±3mm (18.7 inches) |
| | Width | 175±3mm (6.89 inches) |
| | Container Height | 328±3mm (12.9 inches) |
| | Total Height | 338±3mm (13.3 inches) |
| Approx Weight | 60.4 Kg (133.2 lbs) | |
| Terminal | M8 | |
| Container Material | ABS | |
| Rated Capacity (25°C) | 1036.0 Ah | (20hr, 51.8A, 1.80V/cell) |
| | 1000.0 Ah | (10hr, 100.0A, 1.80V/cell) |
| | 857.5 Ah | (5hr, 171.5A, 1.75V/cell) |
| | 756.3 Ah | (3hr, 252.1A, 1.75V/cell) |
| | 520.7 Ah | (1hr, 520.7A, 1.67V/cell) |
| Max. Discharge Current | 8000A (5s) | |
| Internal Resistance (25°C) | Approx 0.45mΩ | |
| Operating Temp. Range | Discharge : -20 ~ 55°C (-4 ~ 131°F) | |
| | Charge : -20 ~ 40°C (-4 ~ 104°F) | |
| | Storage : -20 ~ 50°C (-4 ~ 122°F) | |
| Nominal Operating Temp. Range | 25±3°C (77±5°F) | |
| Cycle Use | Initial Charging Current less than 250.0A. Voltage 2.35V~2.40V at 25°C(77°F)Temp. Coefficient -5mV/°C | |
| | Initial Charging Current less than 250.0A. Voltage 2.23V~2.27V at 25°C(77°F)Temp. Coefficient -3mV/°C | |
| Effect of temp. to Capacity | 40°C (104°F) | 103% |
| | 25°C (77°F) | 100% |
| | 0°C (32°F) | 86% |
| Self Discharge | LPGS series batteries may be stored for up to 6 months at 25°C(77°F) and then a freshening charge is required. For higher temperatures the time interval will be shorter. | |



DIMENSIONS

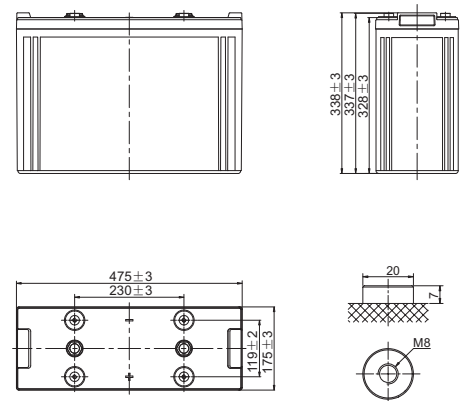

CONSTANT CURRENT DISCHARGE (AMPERES) AT 25°C (77°F)

| F.V/Time | 10min | 15min | 20min | 30min | 45min | 1h | 2h | 3h | 4h | 5h | 6h | 8h | 10h | 20h |
|------------|--------|--------|--------|-------|-------|-------|-------|-------|-------|-------|-------|-------|-------|------|
| 1.85V/cell | 1134.0 | 1000.1 | 900.1 | 744.5 | 590.4 | 477.2 | 296.9 | 238.7 | 188.5 | 162.1 | 138.8 | 111.8 | 95.3 | 50.7 |
| 1.80V/cell | 1340.8 | 1136.0 | 1002.0 | 798.9 | 621.1 | 500.7 | 313.3 | 251.0 | 197.0 | 170.2 | 145.0 | 116.2 | 100.0 | 51.8 |
| 1.75V/cell | 1512.1 | 1248.1 | 1080.1 | 846.0 | 653.1 | 504.2 | 326.2 | 252.1 | 203.5 | 171.5 | 148.5 | 118.3 | 100.8 | 52.5 |
| 1.70V/cell | 1623.1 | 1332.0 | 1155.2 | 887.7 | 674.2 | 507.0 | 335.8 | 254.5 | 208.1 | 172.7 | 151.0 | 120.2 | 101.5 | 53.2 |
| 1.67V/cell | 1683.5 | 1368.2 | 1155.2 | 909.3 | 692.5 | 520.7 | 340.9 | 256.3 | 210.2 | 173.8 | 152.3 | 121.0 | 102.2 | 53.3 |
| 1.60V/cell | 1812.4 | 1446.2 | 1235.0 | 947.4 | 716.9 | 540.2 | 350.1 | 259.0 | 214.0 | 176.5 | 154.7 | 122.7 | 103.8 | 54.0 |

CONSTANT POWER DISCHARGE (WATTS/CELL) AT 25°C (77°F)

| F.V/Time | 10min | 15min | 20min | 30min | 45min | 1h | 2h | 3h | 4h | 5h | 6h | 8h | 10h | 20h |
|------------|--------|--------|--------|--------|--------|--------|-------|-------|-------|-------|-------|-------|-------|-------|
| 1.85V/cell | 2132.0 | 1892.1 | 1710.6 | 1423.1 | 1135.4 | 921.7 | 576.5 | 464.6 | 368.8 | 318.5 | 273.5 | 221.3 | 189.2 | 100.5 |
| 1.80V/cell | 2480.4 | 2118.9 | 1882.0 | 1513.7 | 1185.0 | 961.4 | 605.3 | 485.3 | 383.8 | 332.8 | 284.7 | 229.2 | 198.0 | 102.7 |
| 1.75V/cell | 2753.4 | 2295.2 | 2005.4 | 1588.0 | 1236.8 | 964.8 | 628.2 | 488.2 | 395.6 | 334.0 | 290.5 | 233.0 | 199.3 | 104.2 |
| 1.70V/cell | 2910.6 | 2421.9 | 2124.0 | 1653.5 | 1270.2 | 966.8 | 643.9 | 489.8 | 402.8 | 335.3 | 295.2 | 236.3 | 200.7 | 105.2 |
| 1.67V/cell | 2987.5 | 2464.3 | 2106.4 | 1679.4 | 1296.7 | 987.1 | 651.3 | 491.2 | 406.2 | 336.6 | 297.0 | 237.5 | 201.7 | 105.5 |
| 1.60V/cell | 3138.6 | 2553.2 | 2220.6 | 1732.0 | 1330.7 | 1015.6 | 664.4 | 496.2 | 411.6 | 340.7 | 300.5 | 240.2 | 204.7 | 106.7 |

LPGS Series-Gel Battery RMTS2-1000(2V1000Ah)



Applications

- Uninterruptable Power System
- Power system communication, military communication, etc.
- Telecommunications
- Network communication including: data transmission, television signal transmission, etc.

General Features

- Adopted advantage AGM-GEL technology
- Operation temperature -20 -55°C
- ≤3% Self discharge @25°

Standards

- IEC 60896 Certified
- Classified as "Very Long Life" according to Eurobat
- CE Certified
- Manufactured in Leoch®IATF16949, OHSAS 18001, ISO 9001 and ISO 14001 certified production facilities

Discharge Characteristics

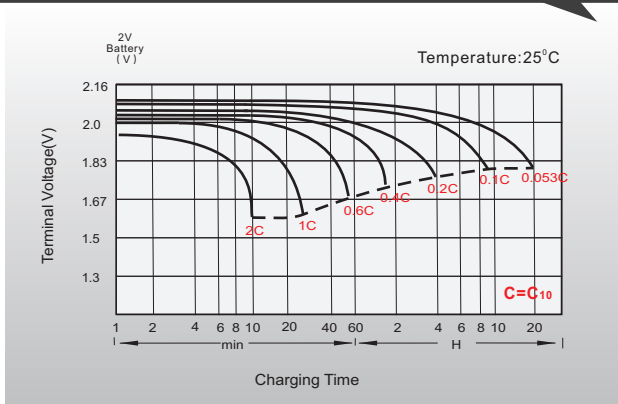

Float Charging Characteristics

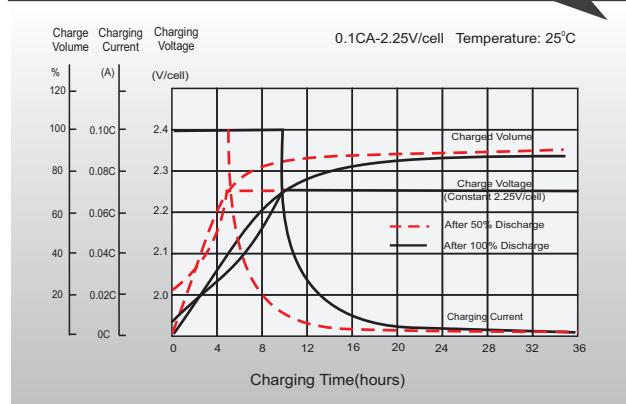

General Relation of Capacity VS. Storage Time

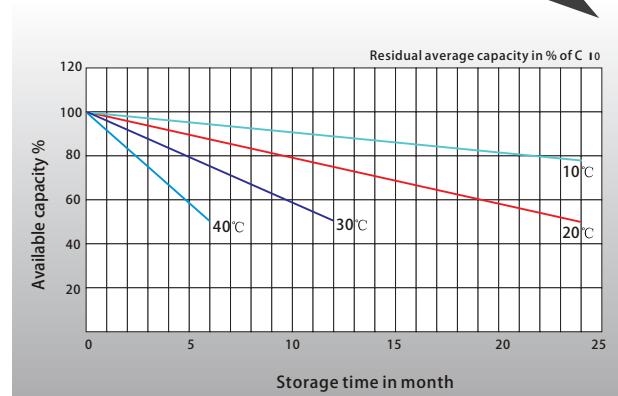

Effect of Temperature on Long term Float life

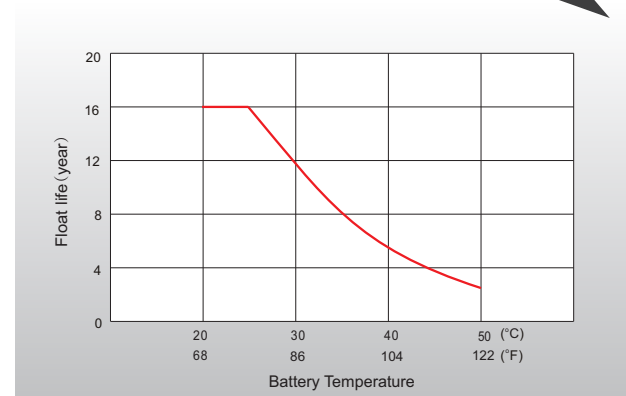

Rematek Énergie, 8975 Boul Henri-Bourassa O,
Saint-Laurent, QC H4S 1P7

Tel: 514 333-6414
rematek-energie.com